

## CDBAS40-06-ME

## Schottky Diode

## Marking: 46

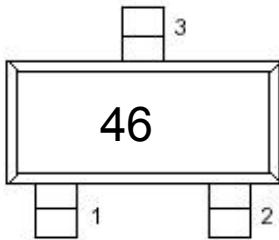

Top view

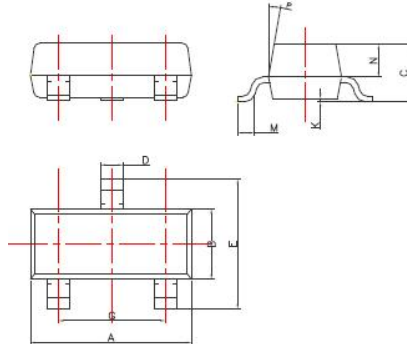

## SOT-23 Dimension

DIM	Millimeters
A	2.85~3.04
B	1.30±0.10
C	1.00±0.10
D	0.45±0.05
E	2.25~2.55
G	1.90±0.1
K	0.00-0.10
M	0.20 min
N	0.60±0.10
P	7±2°

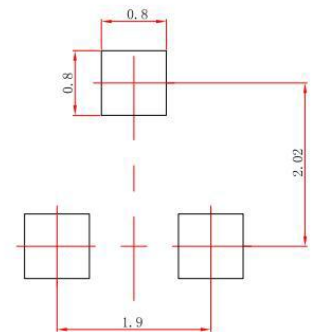
SOT-23  
Suggested Layout

(±0.05mm)

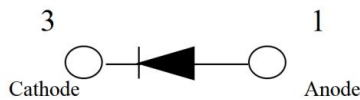

## MAXIMUM RATINGS (Ta=25°C)

Characteristic	Symbol	Rating	Unit
Reverse Voltage	$V_R$	40	Vdc
Peak Forward Current	$I_F$	350	mAdc
Peak Forward Surge Current	$I_{FM}(\text{surge})$	1.5	Adc

## THERMAL CHARACTERISTICS

Characteristic	Symbol	Max	Unit
Total Device Dissipation FR-5 Board(1) $T_A=25^\circ\text{C}$	$P_D$	225	mW
Total Device Dissipation Alumina Substrate,(2) $T_A=25^\circ\text{C}$	$P_D$	300	mW
Junction and Storage Temperature	$T_{J,}$ $T_{stg}$	150 , -55 ~50	$^\circ\text{C}$

- FR-5=1.0×0.75×0.062in, printed-circuit board.
- Alumina=0.4×0.3×0.024in, 99.5%alumina

# CDBAS40-06-ME

## Schottky Diode

### ELECTRICAL CHARACTERISTICS (T<sub>A</sub>=25°C unless otherwise noted)

Characteristic	Symbol	Test Condition	Min	Type	Max	Unit
Reverse Voltage Leakage Current	I <sub>R</sub>	V <sub>R</sub> =25Vdc	--	--	1.0	μA
Reverse Breakdown Voltage	V <sub>(BR)</sub>	I <sub>BR</sub> =10 μA dc	40	--	--	Vdc
Forward Voltage	V <sub>F</sub>	I <sub>F</sub> =20mA dc	--	--	370	mV
		I <sub>F</sub> =200mA dc	--	--	600	
Total Capacitance	C <sub>T</sub>	V <sub>R</sub> =1V, f=1.0MHz	--	--	5.0	pF

## Schottky Diode

### Typical Characteristics

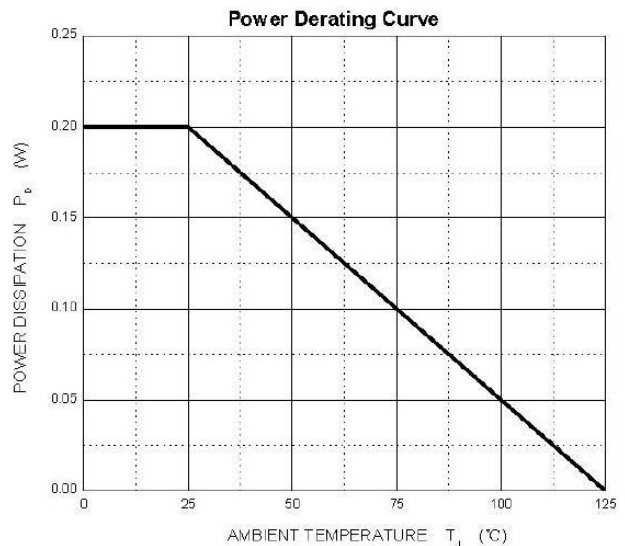
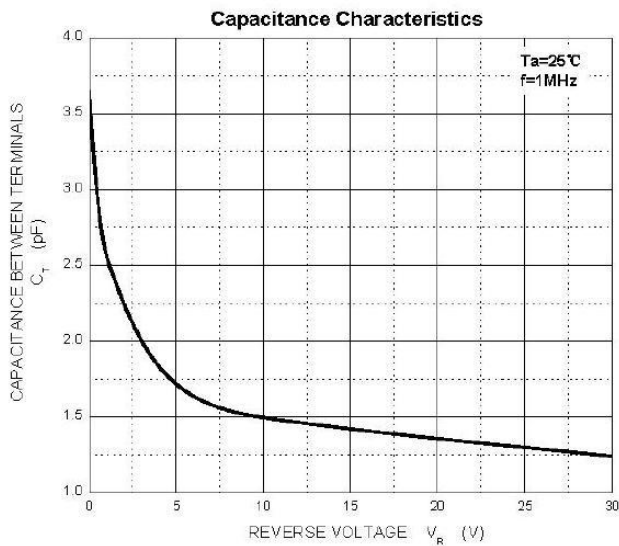
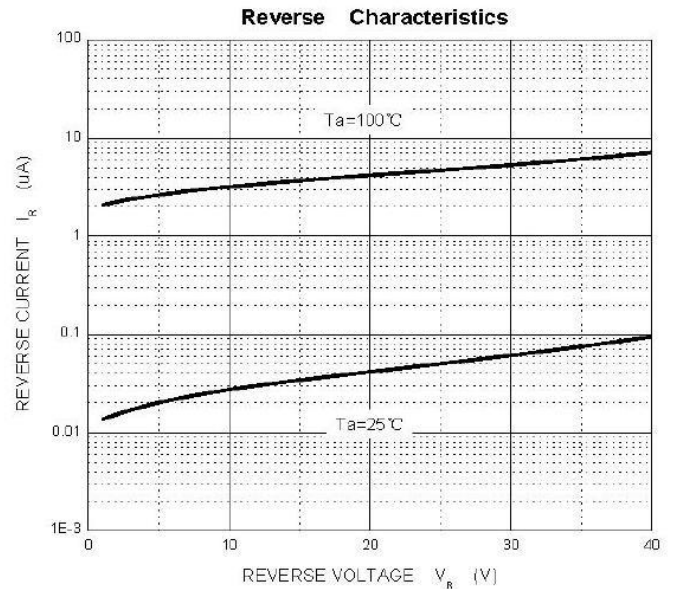
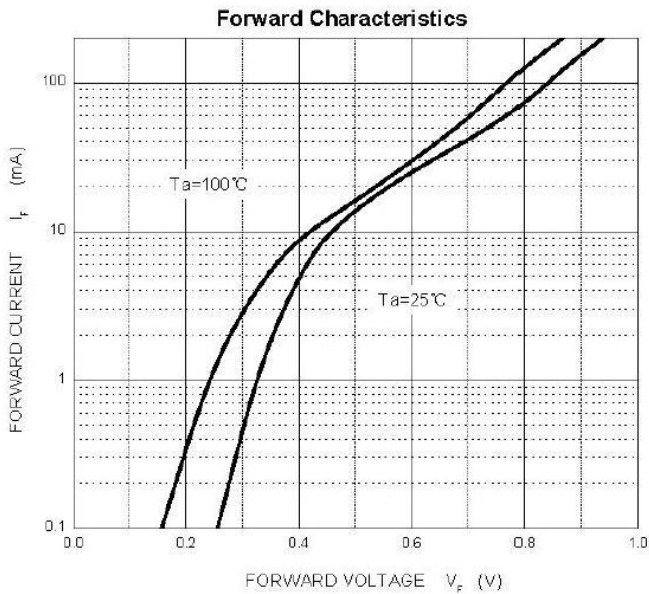

Note: Specifications are subject to change without notice. For more detail and update, please visit our website.